

RQ Series

Low Torque Rotary Joint



RQ Series

Low Torque Rotary Joint

Standard: JIS

Type: Metal Seal Type

Long service life

1 billion rotations

- RQ1 : 1 billion rotations
- RQ2 : 0.5 billion rotations
- RQ4 : 0.3 billion rotations
- RQ8 : 0.2 billion rotations
- RQ12: 0.1 billion rotations
- RQ16: 0.1 billion rotations

Low rotational torque

0.003 to 0.50 N·m or less

Allowable RPM

200 to 3000 min⁻¹ (rpm)

Operating temperature

-10 to 80°C

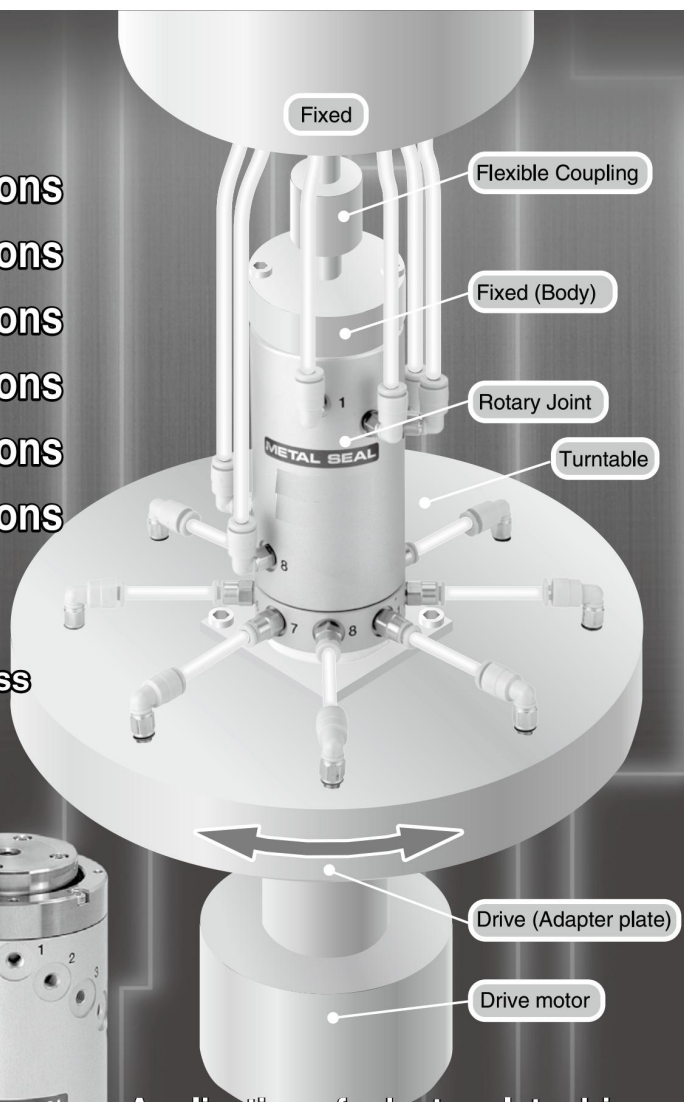

Application of adapter plate drive

* Not suitable for transmission of drive



RQ Series Low Torque Rotary Joint

KATIX

Rotational torque unaffected by supply pressure and temperature fluctuations

Use of metal seals prevents the spool from sticking to the rotating surface even after a long period of non-operation.

Operating pressure **-100 kPa to 1 MPa**

Piping ports are aligned in a spiral line for easy piping

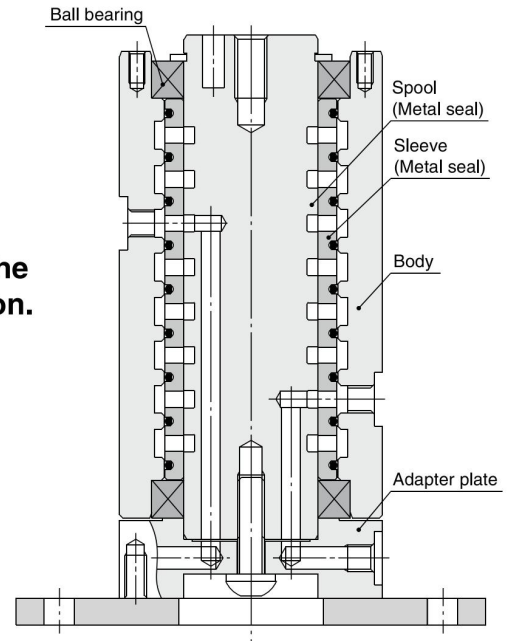

Applications: Air supply to rotary/pivot shafts of turntables and robot arms

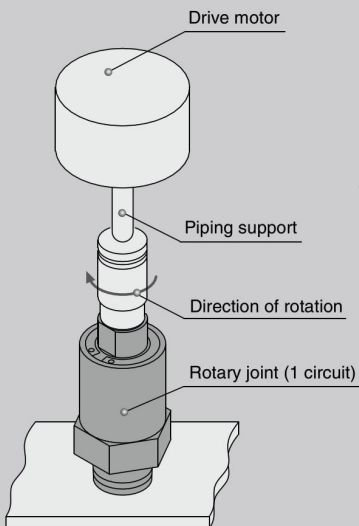

Example of 1 circuit

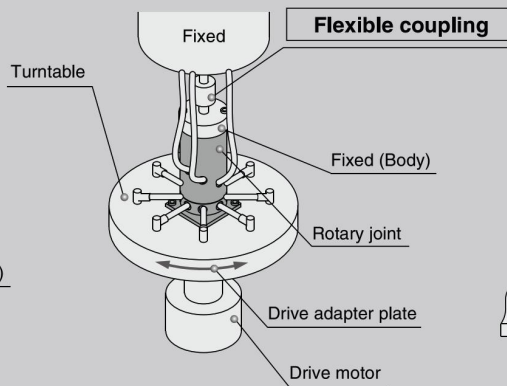

Example of adapter plate drive

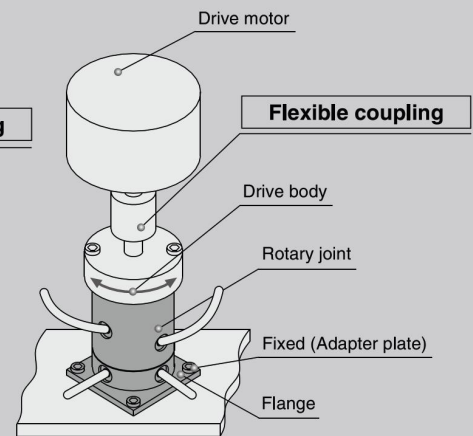

* This series cannot be used for drive transmission.

Example of body drive

RQ Series

Low Torque Rotary Joint

Standard: JIS

Type: Metal Seal Type

How to Order

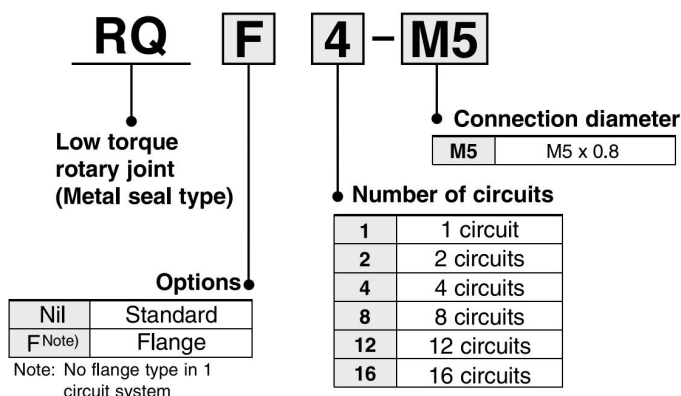

Options/Mounting Bracket

Number of circuits	Flange part number
2 circuits	RQ2-F
4 circuits	RQ4-F
8 circuits	RQ8-F
12 circuits	RQ12-F
16 circuits	RQ16-F

Specifications

Model	RQ1-M5	RQ2-M5	RQ4-M5	RQ8-M5	RQ12-M5	RQ16-M5
Number of circuits (Number of ports)	1	2	4	8	12	16
Fluid	Air					
Seal structure	Metal seal					
Guide structure	Bearing supported		Bearing supported at both ends			
Port size	Male R 1/8		M5 x 0.8			
	Female M5 x 0.8					
Flow rate characteristics	C		0.50 [dm ³ /(s·bar)]			
	b		0.40			
	Cv		0.17			
Lubrication	Not required					
Min. operating pressure	-100 kPa					
Max. operating pressure	1.0 MPa					
Ambient temperature and operating fluid temperature ^{Note 1)}	-10 to 80°C					
Maximum start-up rotation torque ^{Note 2)}	0.003 N·m or less	0.03 N·m or less	0.05 N·m or less	0.10 N·m or less	0.20 N·m or less	0.50 N·m or less
Allowable rotation number ^{Note 5)}	3000 min ⁻¹ (rpm) or less ^{Note 3)}	2000 min ⁻¹ (rpm) or less	1500 min ⁻¹ (rpm) or less	900 min ⁻¹ (rpm) or less	600 min ⁻¹ (rpm) or less	200 min ⁻¹ (rpm) or less
Allowable radial load (allowable coupling axis reaction) ^{Note 4)}	1 N or less	15 N or less	30 N or less	40 N or less	50 N or less	50 N or less
Allowable axial load						
Weight	0.025 kg	0.16 kg	0.39 kg	0.76 kg	1.26 kg	2.80 kg

Note 1) The temperature 80°C includes temperature rise during rotation.

Note 2) The start-up torque does not change with the supply pressure or with non-use (remains within the maximum start-up rotation torque), but it does change with the rotation number.

Note 3) If using at a speed above 600 min⁻¹ (r.p.m.), ensure rotation is in the direction in which the joint is fastened.

Note 4) Rubber / resin couplings are recommended due to their excellent absorption of off center, shocks, and vibrations.

Note 5) min⁻¹: Number of rotations per 1 minute

RQ Series Low Torque Rotary Joint

KATIX

Construction

RQ1-M5

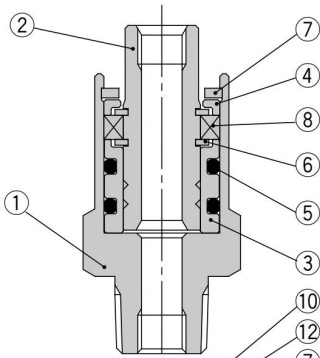

RQ2 to 16-M5

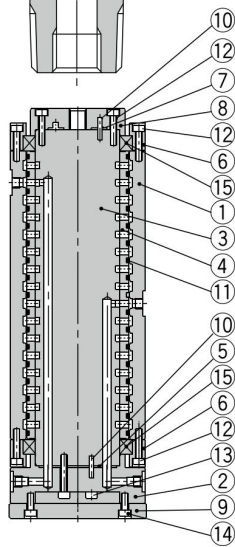

Component Parts/(RQ1 - M5, 1 circuit)

No.	Name	Material	Remarks
1	Body	Stainless steel	
2	Spool	Special stainless steel	
3	Sleeve	Special stainless steel	
4	Plate	Aluminium	
5	O-ring	H-NBR	
6	Retaining ring	Carbon steel	
7	Retaining ring	Carbon steel	
8	Radial bearing		

Component Parts/(RQ2 to 16 - M5, 2 to 16 circuits)

No.	Name	Material	Remarks
1	Body	Aluminum	
2	Adapter plate	Aluminum	
3	Spool	Special stainless steel	
4	Sleeve	Special stainless steel	
5	Gasket	H-NBR	
6	Bearing holder	Stainless steel	16 circuits only
7	Gasket	H-NBR	16 circuits only
8	Plate	Aluminum	16 circuits only
9	Flange	Aluminum	
10	Parallel pin	Carbon steel	Except for 2 circuits
11	O-ring	H-NBR	
12	Bolt	Carbon steel	16 circuits only
13	Bolt	Carbon steel	
14	Bolt	Carbon steel	
15	Radial bearing	—	

Leakage according to differential pressure

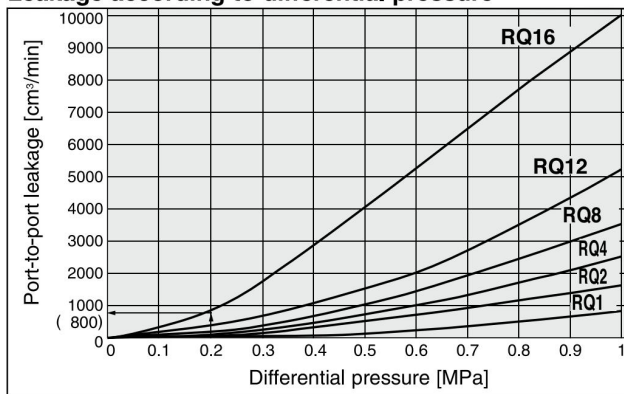

Note) These values show reference values and are not guaranteed.

Temperature rise with rotation number

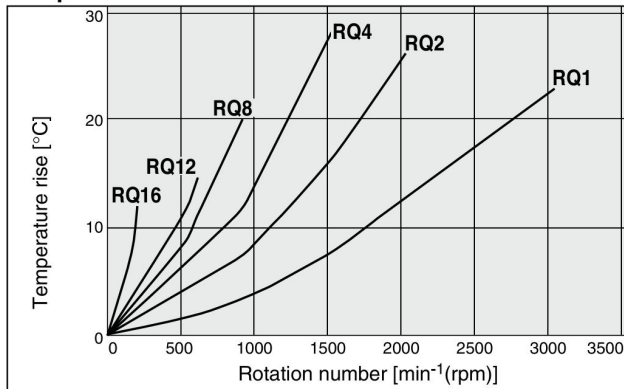

Note: Value when no pressure applied. Temperature rise is reduced by supply of air.

Note: These values show reference values and are not guaranteed.

e.g.: If adjacent ports are connected to vacuum pressure of -0.1 MPa and positive pressure of 0.1 MPa in RQ16, then differential pressure is 0.2 MPa, and leakage is 800 (cm³/min).

Change in rotational torque with rotation number

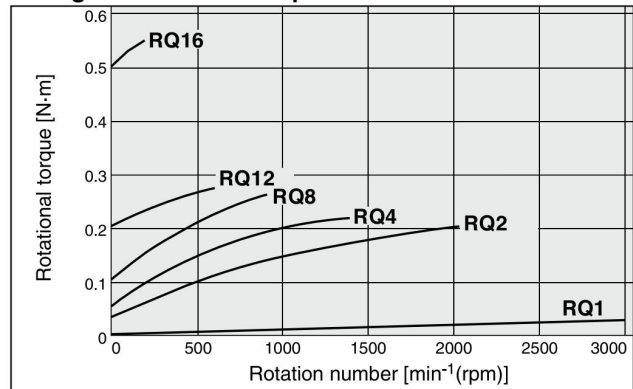

Note) These values show reference values and are not guaranteed.

RQ Series Low Torque Rotary Joint

KATIX

Dimensions: Standard Type/Flange Type

* Symbol indicates flange dimensions

RQ12-M5

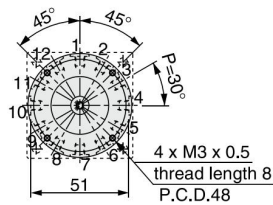
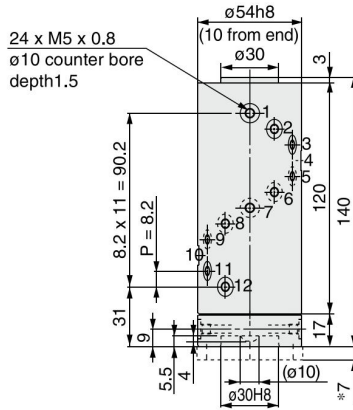
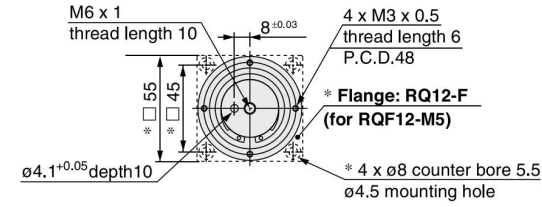

RQ16-M5

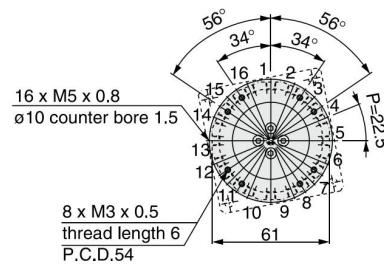
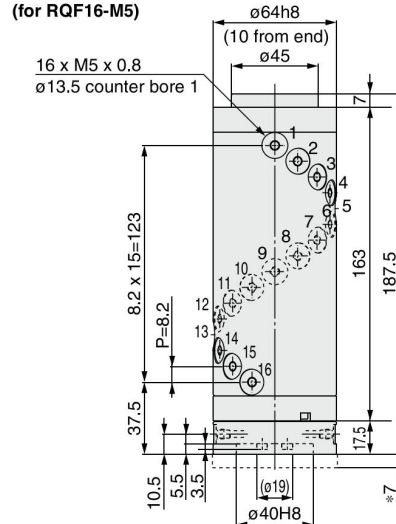
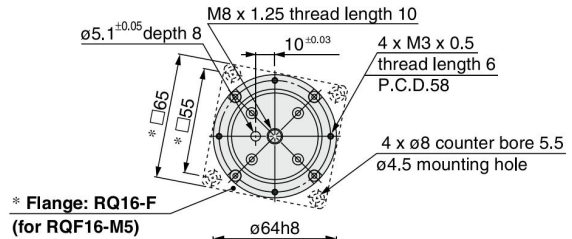

Mounting Bracket/Flange

RQ2-F

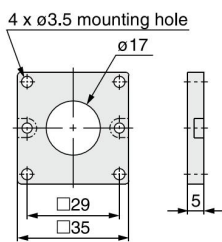

RQ4-F

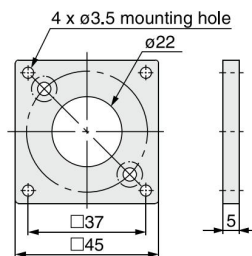

RQ8-F

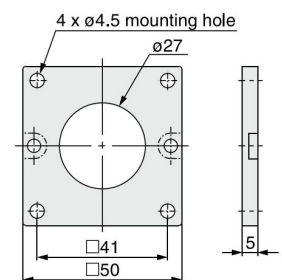

RQ12-F

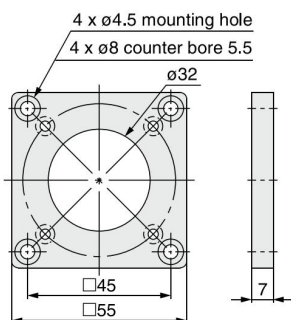

RQ16-F

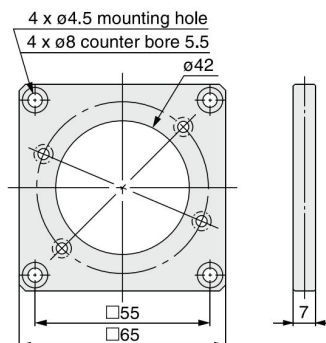

KATIX



Contact us for more details

+91 9053-888-011

www.katixpneumatic.com

KATIX[®]

KATIX PNEUMATIC INDIA PVT. LTD.

Plot No.- 198, Sector - 9, HSIIDC
IMT Bawal, Haryana - 123501, India

T: +91 9053-888-011

E: info@katix.in